

# Work Equipment Wear Parts

## IRS639

Spike puller claw forged  
Fits Nordco spike puller  
OEM 46650037  
BTI-200825

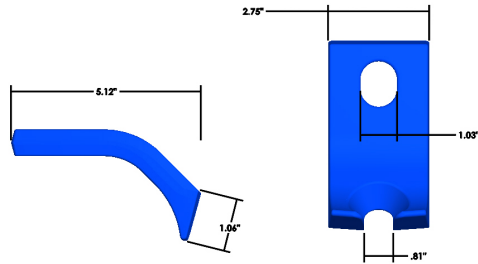

## IRS630B

Wear resistant rail clamp with bolts, washers, insulator, and insulated washers  
Fits Jackson Tamper  
OEM 2320331, 2000784  
BTI-196101

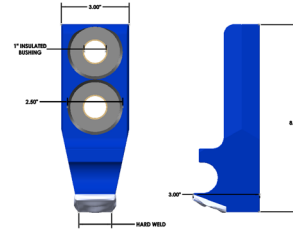

## IRS611

Adzer Bit round with tungsten carbide  
Fits Kershaw Crawler Adzer  
OEM 580432  
BTI-110-T

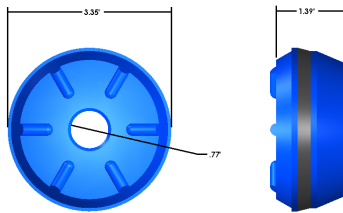

## IRS218BE

Broom element standard 2" x 18"  
OEM B-27738



## IRS218BECS

Broom element, heavy club style  
BTI-199138



## IRS650

Wear resistant rail clamp; threaded, with bolts  
Fits Harsco Tamper  
OEM 1050541  
BTI-197940

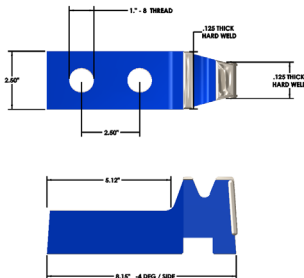

## IRS628

Double broom element clamp-forged  
BTI-198845

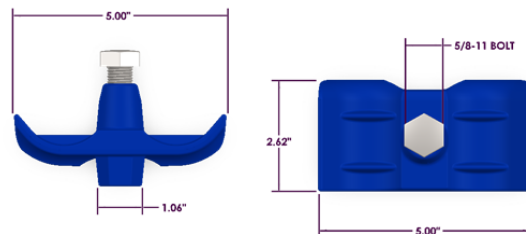

**INDUSTRY-RAILWAY SUPPLIERS, INC.**

**800-728-0029**

577 West Lamont Rd.  
Elmhurst, IL 60126

Phone 1-800-728-0029  
Phone 630-766-5708

Fax 630-766-0017  
www.industryrailway.com

# Work Equipment Wear Parts

## IRS609

Plow blade, 3 hole outboard, Chromium carbide  
 Fits Knox Kershaw and Kershaw, all regulators  
 OEM 194485, 116656, 9015532, 9001087 9011359,  
 043683037  
 BTI-197750, 740-MAX

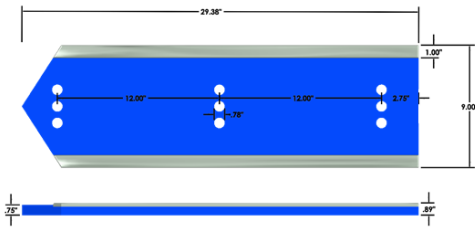

## IRS631

Plow Blade, Chromium carbide  
 Weldment on both sides for left and right hand use  
 Fits Knox Kershaw Regulator Model KBR-850, 875 and 900  
 series  
 OEM 9001019  
 BTI-302468

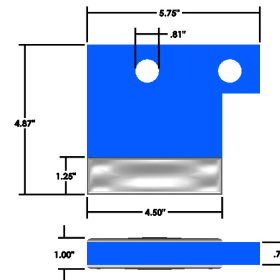

## IRS606

Plow blade, 2 Hole long, Chromium carbide  
 Fits Knox Kershaw and Kershaw, all regulators  
 OEM 194486, 9015531, 116657, 155153  
 BTI-197740, 730-MAX

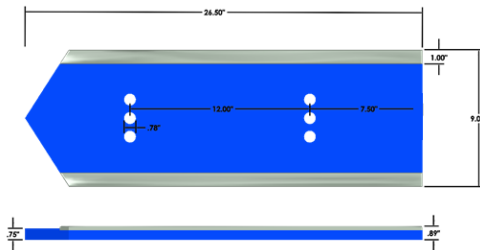

## IRS605C

Skid Plate 7 inch  
 3/8\" Chromium Carbide front skid shoe  
 Fits Kershaw and Knox Kershaw, all regulators  
 OEM 9031952, 176386, 109617, 109617A, 109617B  
 BTI-750-1-7

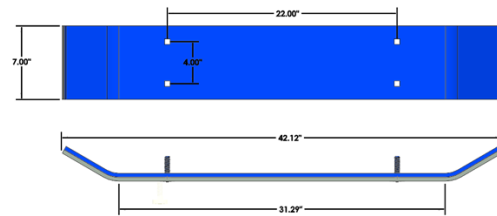

## IRS633

Plow Blade, 2 hole short inboard, Chromium carbide  
 Fits Knox Kershaw Regulator Model KBR-850, 875, 885 and 900 series  
 OEM 9001018  
 BTI-200602

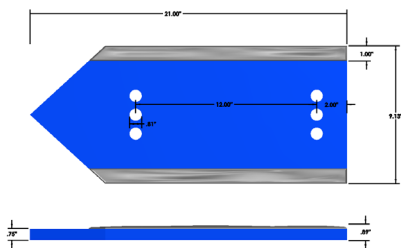

## IRS605-6C

Skid Plate 6 inch  
 3/8\" Chromium Carbide front skid shoe  
 Fits Kershaw and Knox Kershaw, all regulators  
 OEM 9001236C, 176386, 109617, 109617A 109617B, 740253  
 BTI-750-1

